

ROCKTRON
TECHNOLOGY FOR GUITARISTS

Mike Orlando

SIGNATURE WAH



MANUAL



Your Mike Orlando Signature Wah pedal has been tested and complies with the following Standards and Directives as set forth by the European Union:

Council Directive(s): 89/336/EEC Electromagnetic Compatibility

Standard(s): EN55013, EN50082-1

This means that this product has been designed to meet stringent guidelines on how much RF energy it can emit, and that it should be immune from other sources of interference when properly used. Improper use of this equipment could result in increased RF emissions, which may or may not interfere with other electronic products.

To insure against this possibility, always use good shielded cables for all audio input and output connections. This will help insure compliance with the Directive(s).

For more information about other Rocktron products, please see your local dealer or one of our importers closest to you (listed on the Rocktron website - www.rocktron.com).

Precautions

Read all instructions contained in this manual.

Keep these instructions

Heed all warnings

Follow all instructions.

Do not use this apparatus near water.

Clean with dry cloth

Precautions Continued....

Do not block any ventilation openings (if applicable). Install in accordance with the manufacturer's instructions.

Do not install near any heat sources such as radiators, heat registers, stoves or other apparatus (including amplifiers) that produce heat.

This product is not equipped with a plug or cable. This pedal runs on a 9 Volt Battery, if a 9-Volt DC adapter is the used please follow adapter manufacturer's operation instructions.

Only used attachments/accessories specified by the manufacturer.

Do not use this product with any case, stand tripod, bracket or table that is not specified by the manufacturer. Insure that the case, stand, tripod, bracket etc. is properly adjusted and setup (follow all instructions). Extra care and caution should be taken to avoid tip over and injury.

Unplug this apparatus during lightening storms or when unused during long periods of time.

Refer all service to qualified service personnel. Servicing is required when the apparatus has been damaged in any way, such as power supply or plug is damaged, liquid has been spilled or objects have fallen into the apparatus or if the apparatus has been exposed to rain or moisture, does not operate normally or has been dropped.

DO NOT ATTEMPT TO SERVICE THIS EQUIPMENT. QUALIFIED PERSONNEL SHOULD SERVICE THIS EQUIPMENT ONLY. DO NOT MAKE ANY INTERNAL ADJUSTMENTS OR ADDITIONS TO THIS EQUIPMENT AT ANY TIME OR TAMPER WITH INTERNAL ELECTRONIC COMPONENTS AT ANY TIME. FAILURE TO FOLLOW THESE INSTRUCTIONS MAY VOID THE WARRANTY OF THIS EQUIPMENT AS WELL AS CAUSING A SHOCK HAZARD.

OPERATING TEMPERATURE

Do not expose this unit to excessive heat. This unit is designed to operate between 32° F and 104° F (0° and 40° C). This unit may not function properly under extreme temperatures.

Introduction

Congratulations on your purchase of the Rocktron Mike Orlando Signature Wah.

Together with Mike we produced a wah pedal like no other. Mike's expressive use of the wah effect required a pedal that not only could take the usage, but has a very musical tone.

Working with Mike we developed three custom voiced settings. Mike mainly uses the CLASSIC setting which is a more "vintage" wah effect. The NORMAL setting provides a more "current" frequency sweep. The BASS setting is ideal for Bass Wah and 7-string guitars, but also provides a new dimension to the standard wah effect on regular 6-string guitars.

We then combined these settings with an extra control called "MIX". This "MIX" control allows you to mix in any amount of wah effect to the direct signal. In the "CLEAN" setting only a very small amount of wah effect is added into the direct signal. In the "WAH" setting it is full-on wah. Back this setting off to half way and you get half wah, half direct signal. This feature is specifically designed for a more expressive use of the wah other than just "wah-wahing". It will add higher frequencies and lower frequencies to your overall tone and allow you to use it rhythmically as well rather than just for solo use.

Like other Rocktron Wah pedals, the Mike Orlando Signature wah is stage ready. The easy access battery compartment will make changing batteries during a gig a breeze. We have incorporated an adjustable rocker tension screw that will allow you to adjust the pedal action for a lighter or heavier "touch".

Connection

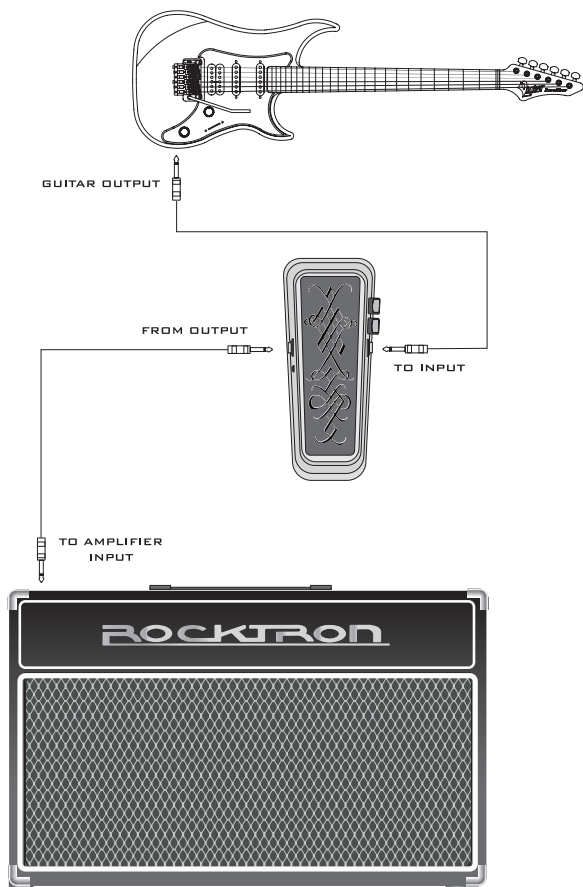

Connection when using with other stomp boxes or effects:

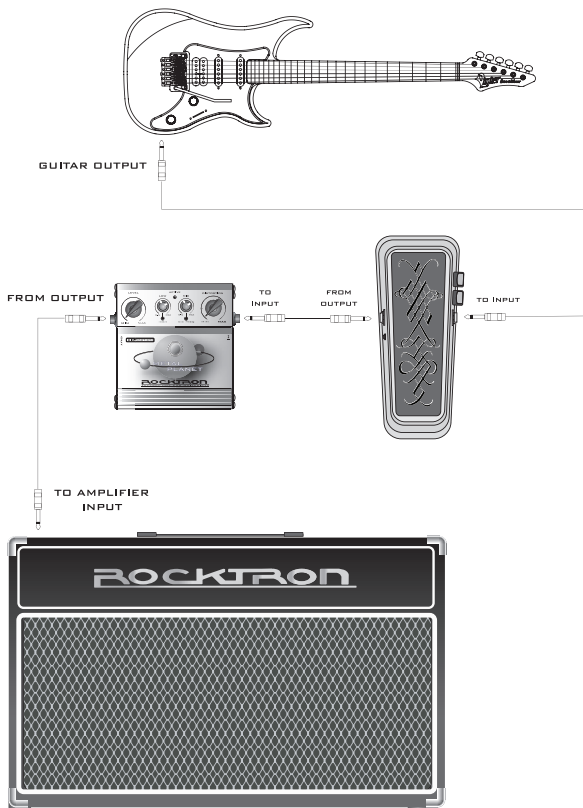

Controls and Descriptions:

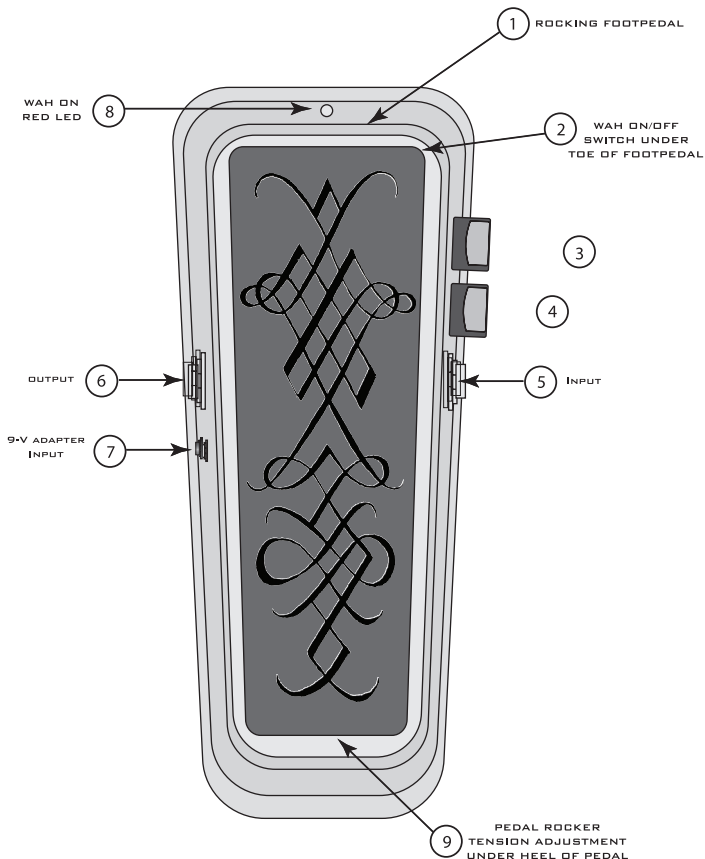

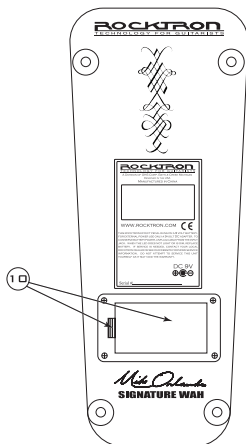
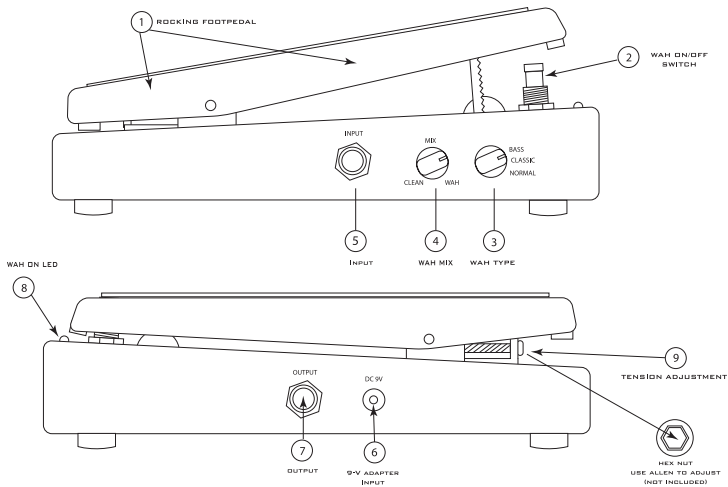

Controls and Function Descriptions

- 1 **ROCKER FOOTPEDAL** - Place your foot on the rocker footpedal and rock it up and down (toe to heel - heel to toe) to work the “wah” effect.
- 2 **Wah ON/OFF Switch** - is located under the toe of the rocker footpedal. To activate the “wah” press down slightly harder on the toe of the rocker pedal until the switch is activated. The same process is to be applied to turn off the wah effect. The wah effect will be on when the red LED is lit (see point 7).
- 3 **WAH TYPE Selector Control** - This control will allow you to select 3 different wah models - Bass, Classic or Normal.
 - o **BASS** - in this position the wah has been voiced to use with a bass or dropped tuned guitars and 7-strings. It also provides a different dimensional tone for 6-string guitars in standard tunings.
 - o **CLASSIC** - in this position the wah voice is changed to a more “vintage” wah tone. Mike uses this position most when playing.
 - o **NORMAL** - in this position the wah is voiced to sound like a “traditional” wah.
- 4 **WAH MIX Control** - This control allows you to mix in the amount of wah effect to the dry signal. When turned full to the “WAH” side the wah effect is 100% in the signal. When turned full to the “Clean” side the wah effect is at the minimum amount mixed in. When the control is at 12 o’clock the wah effect and dry signal is 50/50

Controls and Function Descriptions - Cont.

- 5 **INPUT Jack** - using a standard guitar cable - plug your guitar into this jack.
- 6 **9-VOLT ADAPTER INPUT** - This receptacle requires a 9V DC adapter (not included) with a 2.1mm coax plug to provide power to the unit. Please consider using the Rocktron DC OnTap adapter (sold separately) available from your Rocktron dealer.

Note: If an adapter other than the Rocktron DC OnTap adapter is used, it needs to be a 9V DC filtered audio grade type with a current rating of 100ma or greater . The plug is a 2.1mm Coax jack (Tip is Negative and Sleeve is Positive). Please follow all instructions that appear on the bottom of the Mike Orlando Signature Wah.

- 7 **OUTPUT Jack** - using a standard guitar cable, plug this output into the next effect in your effect chain or directly into the input of your guitar amplifier.
- 8 **WAH ON LED** - The red LED will be lit when the “wah” effect is activated. To activate the wah - see point 2. The red LED will not be lit when the wah is bypassed.
- 9 **PEDAL ROCKER TENSION ADJUSTMENT** - This screw will allow you to adjust the “action” of the pedal to suit your taste with the included allen wrench. If you would like a tighter or heavier movement of the pedal using an allen wrench turn the screw clockwise. This will increase the torque and tension on the rocker pedal. If you would like a smoother or softer pedal movement turn the allen screw counter-clockwise. This will loosen the tension on the pedal pivot point.

Controls and Function Descriptions - Cont.

- 10 **9-VOLT BATTERY COMPARTMENT** - to access pull on small tab labeled "OPEN". Replace with a new 9-Volt battery. Always remember to unplug your guitar cords from the pedal to conserve battery life. Some battery drain may take place when unit is plugged in (even if the unit is bypassed).

Hints and Tips

Place the Mike Orlando Signature Wah (as with all Wah Wah pedals) at the beginning of your signal chain. Although, you may place your wah at any place in your signal chain, it usually sounds best at the beginning - directly from your guitar (or bass).

Specifications

Maximum Input	+10dBu
Input Impedance	1M ohm
Output Impedance	1K ohm
Wah frequency Range	400Hz (Heel Down) to 2KHz (Toe Down)
Current Consumption	20ma or greater
Power Requirements	9VDC >=100ma



MIKE ORLANDO

Mike Orlando is a guitarist/artist that fronts Mike Orlando's Sonic Stomp instrumental band. Mike released his debut Instrumental CD "Sonic Stomp" in 2006 to worldwide critical acclaim. Sonic Stomp's 12 tracks take the listener from raging over-the-top extreme rock guitar playing, with sheer finesse and lightening speed, to beautiful ballads with great emotional feel and everything in between.



In November 2010 Mike released the follow-up CD, Sonic Stomp II which takes Mike's playing & composing to a complete other level of virtuosity & command of the instrument. Additionally, both Sonic Stomp and Sonic Stomp II will be released by King Records in Japan In March 2011. A number of phenomenal guest artists are featured on Sonic Stomp II including Michael Romeo (Symphony X), Shane Gibson (Korn), Gary Hoey, Mike Pinella (Symphony X) and Joe Stump. Sonic Stomp II also features world renowned drummer extraordinaire John Macaluso (Yngwie Malmsteen, TNT, James Labrie-Dream Theater, Tony Harnell, Ark).



Mike Orlando's Debut Sonic Stomp CD has held the number one slot in multiple categories on Guitar 9 records, as well as one of the top sellers of the year in the following categories: overall heavy electric, hard rock and shred. The newly released Sonic Stomp II has already hit # 1 as well on Guitar 9 records. Mike has also performed with Sonic Stomp at 4 previous NAMM shows and held signings for GHS and Rocktron, as well as multiple performances at Musikmesse Germany & Music China Shanghai in the last 2 years.



Many songs from Mike Orlando's Sonic Stomp and Sonic Stomp II Cd's are available on the world famous ROCK-BAND Game! During 2011 all tracks from both Sonic Stomp CD's will be available to purchase & play in the online ROCKBAND Store.

Mike is also a featured guitarist on Magna Carta's February 10, 2009 release "Guitars That Ate My Brain", which features 10 of metal's premier guitarists.



2011 will bring the release of the newly formed explosive hard rock band UNDAUNTED where Mike has joined forces with world renowned artist/vocalist Russell Allen from the band Symphony X. UNDAUNTED is currently in the recording studio completing songs for the debut CD to be released in 2011. Mike has also teamed up with Russell Allen on Russell's solo album Skull & Bones to be released in 2011 on Frontier Records.

In 2008 Mike was selected as a top ten finalist worldwide for Guitar Player Magazine's Guitar Superstar of the Year from thousands of passionate guitarists worldwide. Since being selected, he has been featured in Guitar Player Magazine several times. In late 2010 Mike was featured in a Guitar World Magazine DVD contributing to the release of Rocktron's new effects pedal launches.



Mike has full endorsements with GHS Strings and Rocktron products along with several other brands. He is one of the featured artists on the GHS Strings and Rocktron sites and performs many of the Rocktron audio clips, including the Tri-Wah, Black Cat Moan, The Banshee Talkbox, Cyborg Delay, Cyborg Reverb, and most of the audio clips for Utopia G100, Utopia G200 & G300 Utopia 300 as well as the entire new line of Rocktron Boutique Pedals & Reaction Series Pedals!

Mike also owns his own recording studio, Sonic Stomp Studios, where he handles everything from engineering to mixing, to producing and mastering. All this can be heard on his debut CD, Sonic Stomp and the newly released Sonic Stomp II.



For more information on Mike Orlando go to:

www.mikeorlandomusic.com

www.myspace.com/mikeorlandomusic

www.twitter.com/mikeorlando1

www.youtube.com/mikeorlandomusic

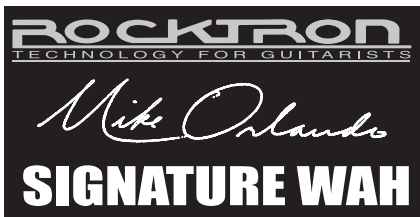

Rocktron - A Division of GHS Corporation
2813 Wilber Ave
Battle Creek MI 49037
USA

Rocktron Phone: 1-(269)-968-3351
Email: info@rocktron.com

www.rocktron.com